

Metric Connectors for Copper Conductor

One-Hole Metric Lugs

Blackburn® metric lugs are manufactured from electrolytic copper tube. The dimensions of the tube are designed to obtain the most efficient electrical conductivity and mechanical strength, resisting vibration and pull out.

Blackburn® metric lugs are annealed to guarantee optimum ductility, which is a necessity for compression connectors having to withstand severe deformation arising when compressed or bending of the tongue that may happen during installation.

Connectors have to perform adequately with vibration loads, and annealing is necessary to avoid material failure between the barrel and the tongue.

The presence of an inspection hole facilitates full insertion of the conductor, and the barrel length is designed to allow easy and accurate positioning of the dies during the crimping operation.

Lugs are electrolytically tin-plated to eliminate oxidation of the copper material. Blackburn® metric lugs complement our connector family and meet a growing need for customer's connector requirements. Details of the appropriate crimping tools and dies are included. Our Technical Services group is always available to provide any technical advice required. Please contact them if sizes are needed additional to those shown in this catalog.



CAT. NO.	COND. SIZE SQMM		Ø STUD MM	DIMENSIONS (MM)						STD. PKG.	6 TON TBM62BSCR (CRIMPS)	14 TON BPLT14BSCRI (CRIMPS)	26 TON TBM26MCC (CRIMPS)	60 TON TBM60MCC (CRIMPS)
	LOW STRANDED	I FLEXIBLE		ØI	B	M	N	L	D					
MCC6M4			4	3,6	8,0	5,0	4,0	21,5	4,3	100				
MCC6M5		4-6	5	3,6	9,0	6,5	6,0	25,0	5,3	100	MCD6-6 (1)	N/A	N/A	N/A
MCC6M6			6	3,6	11,0	7,0	6,0	25,5	6,4	100				
MCC10M4			4	4,6	10,0	5,0	4,0	22,5	4,3	100				
MCC10M5*			5	4,6	10,0	6,5	6,0	26,0	5,3	100				
MCC10M6*		10	6	4,6	11,0	7,0	6,0	26,5	6,4	100	MCD10-6 (1)	MCD10-14 (1)	N/A	N/A
MCC10M8*			8	4,6	15,0	9,0	8,0	30,5	8,4	100				
MCC10M10*			10	4,6	18,0	11,0	10,0	34,5	10,5	100				
MCC16M4*			4	5,8	11,5	5,0	4,0	25,5	4,3	100				
MCC16M5*			5	5,8	11,5	6,5	6,0	29,0	5,3	100				
MCC16M6*		16	6	5,8	11,5	7,0	6,0	29,5	6,4	100	MCD16-6 (1)	MCD16-14 (1)	N/A	N/A
MCC16M8*			8	5,8	15,0	9,0	8,0	33,5	8,4	100				
MCC16M10*			10	5,8	18,0	11,0	10,0	37,5	10,5	100				
MCC25M5*			5	7,0	14,0	6,5	6,0	31,5	5,3	100				
MCC25M6*		25	6	7,0	14,0	7,0	6,0	32,0	6,4	100	MCD25-6 (1)	MCD25-14 (1)	N/A	N/A
MCC25M8*			8	7,0	15,0	9,0	8,0	36,0	8,4	100				
MCC25M10*			10	7,0	18,0	11,0	10,0	40,0	10,5	100				
MCC35M5*			5	8,9	17,0	6,5	6,0	34,0	5,3	100				
MCC35M6*			6	8,9	17,0	7,0	6,0	34,5	6,4	100				
MCC35M8*	35	25	8	8,9	17,0	9,0	8,0	38,5	8,4	100	MCD35-6 (1)	MCD35-14 (1)	N/A	N/A
MCC35M10*		35	10	8,9	19,0	11,0	10,0	42,5	10,5	100				
MCC35M12*			12	8,9	21,0	14,0	12,0	47,5	13,2	50				
MCC50M8*		35	8	10,0	19,0	9,0	8,0	42,5	8,4	50	MCD50-6 (2)	MCD50-14 (1)	N/A	N/A
MCC50M10*	50	50	10	10,0	20,0	11,0	10,0	46,5	10,5	50				
MCC50M12*			12	10,0	21,0	14,0	12,0	51,5	13,2	50				
MCC70M6*			6	11,3	21,0	8,0	7,0	44,0	6,4	50				
MCC70M8*			8	11,3	21,0	9,0	8,0	46,0	8,4	50				
MCC70M10*	70	50	10	11,3	21,0	11,0	10,0	50,0	10,5	50	MCD70-6 (2)	MCD70-14 (1)	N/A	N/A
MCC70M12*		70	12	11,3	22,0	14,0	12,0	55,0	13,2	50				
MCC70M16*			16	11,3	26,0	18,0	16,0	63,0	17,0	50				
MCC95M8*			8	13,5	25,0	9,0	8,0	52,5	8,4	25	MCD95-6 (2)	MCD95-14 (1)	N/A	N/A
MCC95M10*	95	70	10	13,5	25,0	11,0	10,0	56,5	10,5	25				
MCC95M12*		95	12	13,5	25,0	14,0	12,0	61,5	13,2	25				

*UL® Listed

Note: See metric compression tools on p. F-100.

Metric Connectors for Copper Conductor

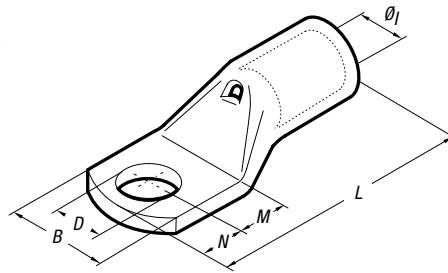

CAT. NO.	COND. SIZE SQMM		Ø STUD MM	DIMENSIONS (MM)						STD. PKG.	6 TON TBM62BSCR (CRIMPS)	14 TON BPLT14BSCRI (CRIMPS)	26 TON TBM26MCC (CRIMPS)	60 TON TBM60MCC (CRIMPS)
	LOW STRANDED	I FLEXIBLE		ØI	B	M	N	L	D					
MCC120M6			8	—	—	—	—	—	6.4	25				
MCC120M8*			8	15,2	28,5	9,0	8,0	54,0	8.4	25				
MCC120M10*	120	95	10	15,2	28,5	11,0	10,0	58,0	10.5	25	MCD120-6 (2)	MCD120-14 (1)	N/A	
MCC120M12*		120	12	15,2	28,5	14,0	12,0	63,0	13.2	25				
MCC120M16*			16	15,2	28,5	18,0	16,0	71,0	17.0	25				
MCC150M12*		120	12	16,7	31,5	16,0	14,0	75,0	13.2	25	MCD150-6 (3)	MCD150-14 (1)	N/A	
MCC150M16*	150	150	16	16,7	31,5	19,0	17,0	81,0	17.0	25			N/A	
MCC185M10*		150	10	19,2	35,5	13,0	11,0	76,0	10.5	25				
MCC185M12*	185	185	12	19,2	35,5	16,0	14,0	82,0	13.2	25	MCD185-6 (3)	MCD185-14 (1)	N/A	
MCC185M16*			16	19,2	35,5	19,0	17,0	88,0	17.0	15				
MCC240M10*		185	10	21,1	39,0	13,0	11,0	82,0	10.5	15				
MCC240M12*	240	240	12	21,1	39,0	16,0	14,0	88,0	13.2	15	MCD240-6 (3)	MCD240-14 (2)	N/A	
MCC240M16*			16	21,1	39,0	19,0	17,0	94,0	17.0	15				
MCC300M10*		240	10	23,7	44,0	20,0	11,0	96,0	10.5	10				
MCC300M12*	300	240	12	23,7	44,0	20,0	14,0	99,0	13.2	10	N/A	MCD300-14 (3)	N/A	
MCC300M16*			16	23,7	44,0	22,0	19,0	10,0	17.0	10				
MCC400M10		300	12	27,0	51,0	22,0	19,0	113,0	13.2	5				
MCC400M12	400	300	12	27,0	51,0	22,0	19,0	113,0	13.2	5	N/A	MCD400-14 (3)	MCD400-26 (2)	
MCC400M16			16	27,0	51,0	22,0	19,0	113,0	17.0	5			MCD400-60 (2)	
MCC500M10		400	16						13.2	5				
MCC500M12	500	400	16						17,0	5	N/A	N/A	MCD500-26 (2)	
MCC500M16			16	30,3	56,5	22,0	19,0	117,0	17,0	5			MCD500-60 (2)	
MCC630M16	630	500	16	33,4	61,6	22,0	19,0	128,0	17,0	6	N/A	N/A	MCD630-26 (2)	
MCC630M20			20	33,4	61,6	24,0	23,0	134,0	21,0	6			MCD630-60 (2)	
MCC800M16	800	630	16	38,0	72,0	24,0	19,0	141,0	17,0	3	N/A	N/A	MCD800-60 (2)	
MCC800M20			20	38,0	72,0	24,0	23,0	145,0	21,0	3				
MCC1000M16	1000	800	16	44,0	80,0	24,0	19,0	158,0	17,0	2	N/A	N/A	MCD1000-60 (2)	
MCC1000M20			20	44,0	80,0	24,0	23,0	162,0	21,0	2				

*UL® Listed

Note: See metric compression tools on p. F-100.

Connectors & Grounding — Blackburn® Compression Connectors Featuring the Color-Keyed® System